

NON INCLUS / NOT INCLUDED

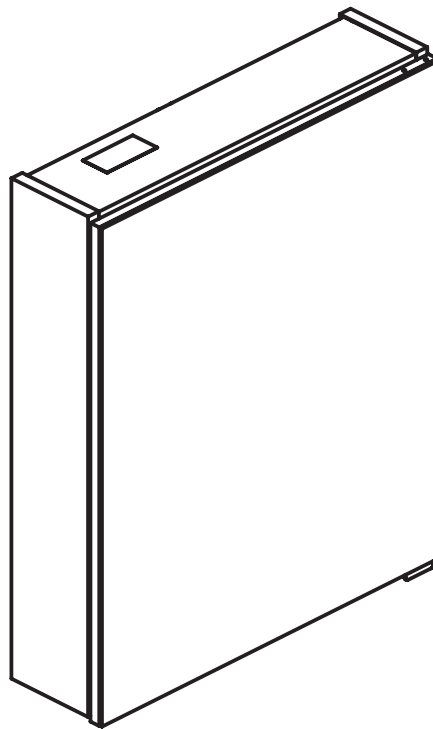

127423

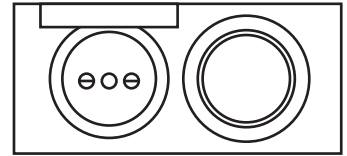

127448

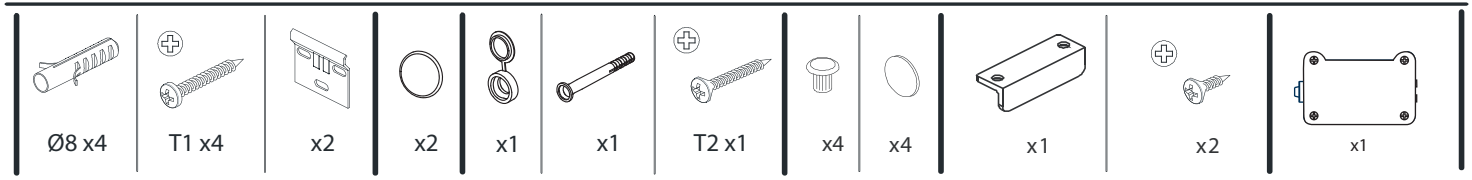
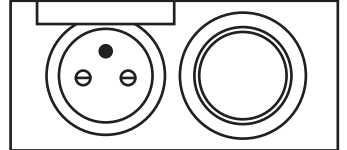

**ES** Por favor, leer detenidamente las indicaciones siguientes para evitar un incorrecta instalación pueda producir un mal funcionamiento del producto. Deben ser realizadas por un instalador cualificado y utilizar los elementos necesarios. La instalación eléctrica general debe cumplir con todos los requisitos reglamentarios. Este aparato pueden utilizarlo niños con edad de 8 años y superior y personas con capacidades físicas, sensoriales o mentales reducidas o falta de experiencia y conocimiento, si se les ha dado la supervisión o formación apropiadas respecto al uso del aparato de una manera segura y comprenden los peligros que implica. Los niños no deben jugar con el aparato. La limpieza y el mantenimiento a realizar por el usuario no deben realizarlos los niños sin supervisión.

Si el cable de alimentación está dañado, debe ser sustituido por el fabricante, por su servicio posventa o por personal cualificado similar con el fin de evitar un peligro.

Deben ser incorporados medios de desconexión a la instalación fija de acuerdo con las reglamentaciones de instalación.

**Importante:** Guardar estas instrucciones para futuros ajustes del mueble.

**EN** Please, read carefully the following instructions to avoid an incorrect installation that could produce a malfunction of the product. It must be carried out by a qualified installer and use the necessary elements. The general electrical installation must comply with all regulatory requirements.

This appliance can be used by children aged from 8 years and above and persons with reduced physical, sensory or mental capabilities or lack of experience and knowledge if they have been given supervision or instruction concerning use of the appliance in a safe way and understand the hazards involved. Children shall not play with the appliance. Cleaning and user maintenance shall not be made by children without supervision.

If the mains cord is damaged, it must be replaced by the manufacturer, its service agent or similarly qualified persons in order to avoid a hazard.

Disconnection means must be incorporated into the fixed installation in accordance with the installation regulations.

**Important:** Keep this instruction sheet for the future adjustments.

**FR** Attention, merci de lire attentivement les indications suivantes pour réaliser une installation correcte afin d'éviter un mauvais fonctionnement du produit. Elle doit être réalisée par un installateur qualifié et utiliser les éléments nécessaires. L'installation électrique générale doit être conforme à toutes les exigences réglementaires.

Cet appareil peut être utilisé par des enfants à partir de 8 ans et des personnes ayant des capacités physiques, sensorielles ou mentales réduites ou un manque d'expérience et de connaissances s'ils ont reçu une supervision ou des instructions concernant l'utilisation de l'appareil en toute sécurité et s'ils comprennent les risques encourus. Les enfants ne doivent pas jouer avec l'appareil. Le nettoyage et l'entretien par l'utilisateur ne doivent pas être effectués par des enfants sans surveillance.

Si le cordon d'alimentation est endommagé, il doit être remplacé par le fabricant, son agent de service ou des personnes de qualification similaire afin d'éviter tout danger.

Les moyens de déconnexion doivent être intégrés à l'installation fixe conformément aux règles d'installation.

**IMPORTANT:** Pour de futurs réajustements du meuble, nous vous conseillons de ne pas jeter ces instructions.

**DE** Bitte, hier geschriebenen Anweisungen genau folgen um eine korrekte Montage zu erreichen. Zumeist wird eine schlechte Arbeitsleistung zu vermeiden. Sie muss von einem qualifizierten Installateur durchgeführt werden und die erforderlichen Elemente verwenden. Die allgemeine Elektroinstallation muss allen gesetzlichen Anforderungen entsprechen.

Dieses Gerät kann von Kindern ab 8 Jahren und darüber sowie von Personen mit verringerten physischen, sensorischen oder mentalen Fähigkeiten oder Mangel an Erfahrung und Wissen benutzt werden, wenn sie beaufsichtigt oder bezüglich des sicheren Gebrauchs des Geräts unterwiesen wurden und die daraus resultierenden Gefahren verstehen. Kinder sollten nicht mit dem Gerät spielen. Die Reinigung und Benutzerwartung darf nicht von Kindern ohne Aufsicht durchgeführt werden.

Wenn das Netzkabel beschädigt ist, muss es durch den Hersteller, seinen Kundendienst oder ähnlich qualifizierte Personen ersetzt werden, um eine Gefährdung zu vermeiden.

In die feste Installation müssen Trennmittel entsprechend den Errichtungsbestimmungen eingebaut werden.

**ACTHUNG:** Behalten Sie diese Aufbausanleitung für zukünftige Badmöbelverstellungen.

01.

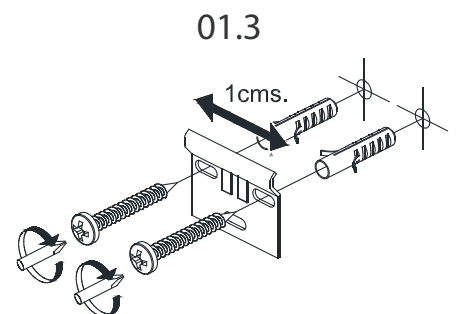
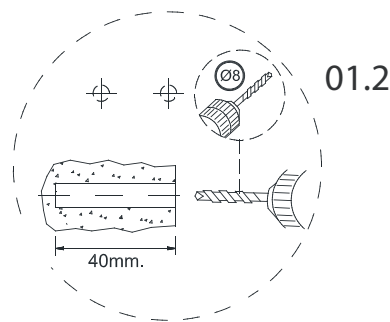
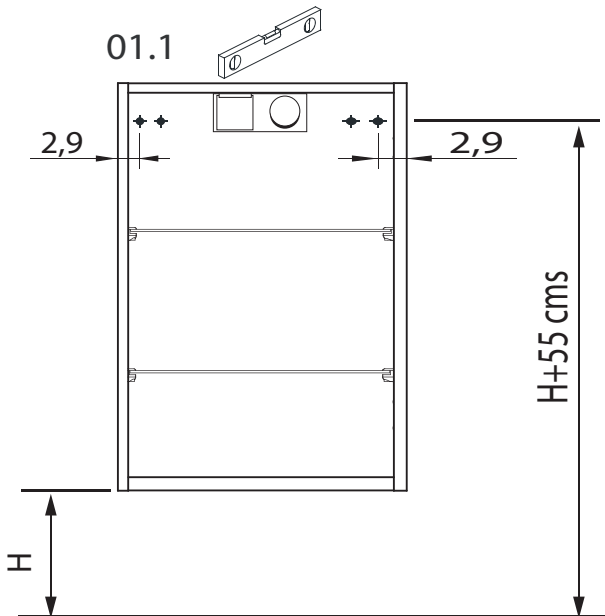
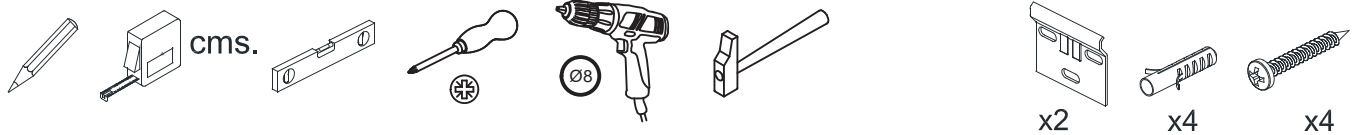

02.

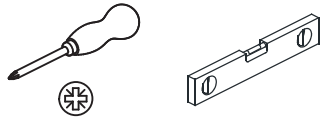

x2

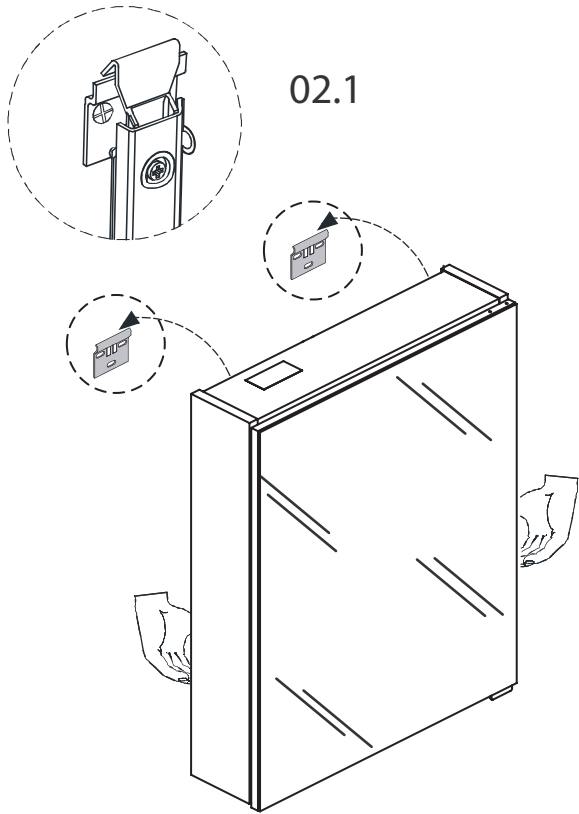

02.1

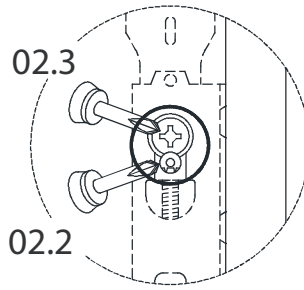

02.3

02.2

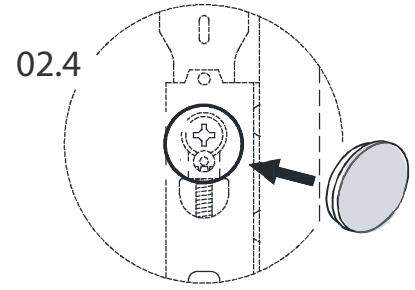

02.4

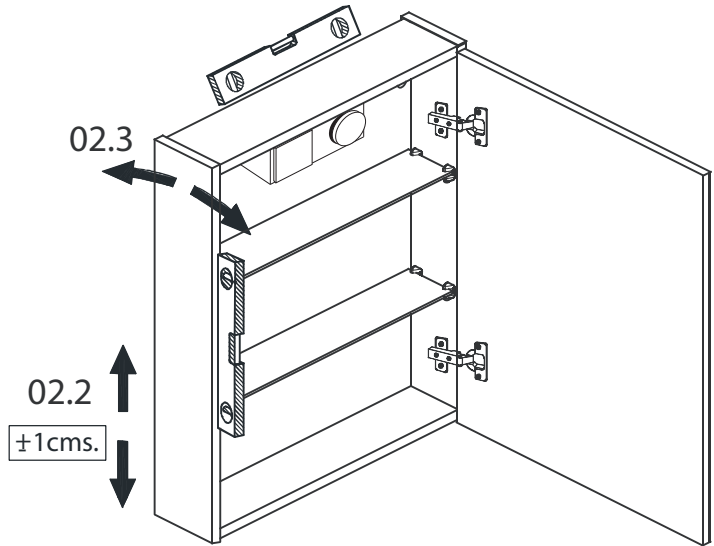

02.3

02.2

±1cms.

03.

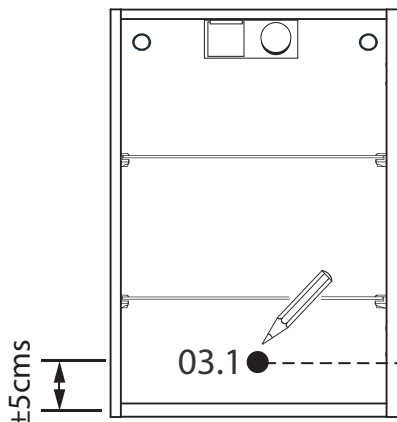
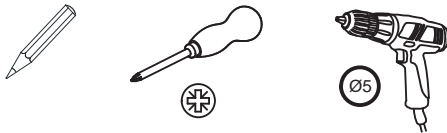

03.1

±5cms

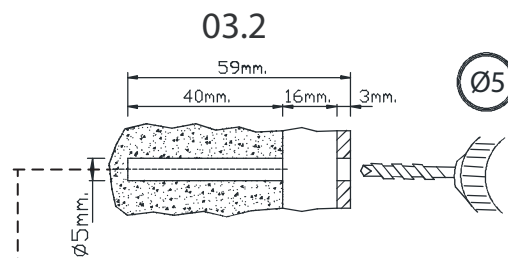

03.2

59mm.  
40mm. 16mm. 3mm.

Ø5mm.

Ø5

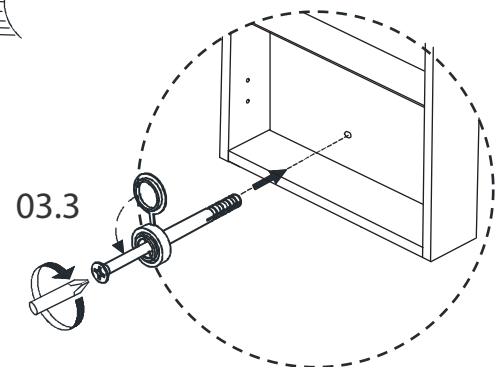

03.3

04.

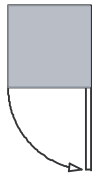
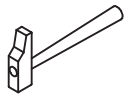

04.1

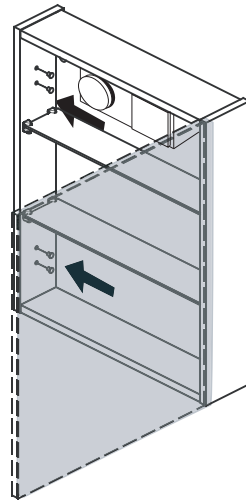

x4

05.

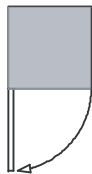

x4

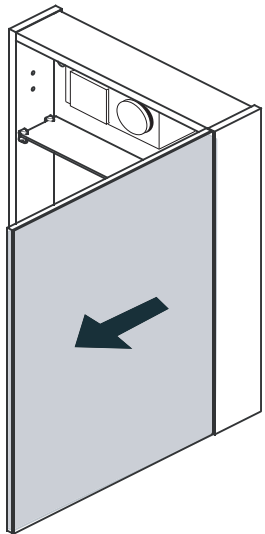

05.1

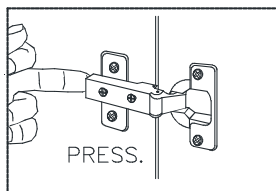

05.2

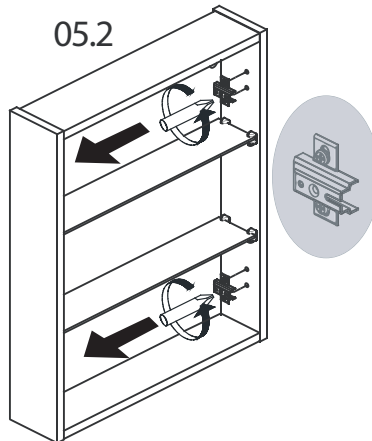

05.3

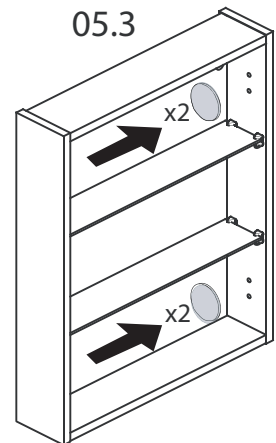

05.4

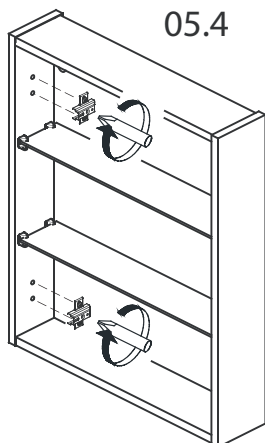

05.5

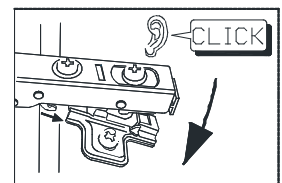
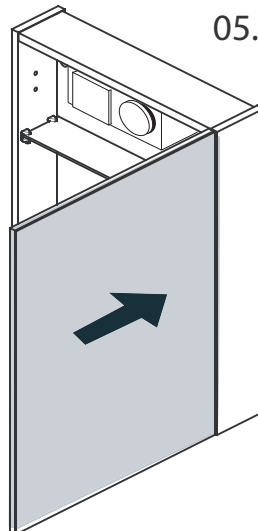

06.

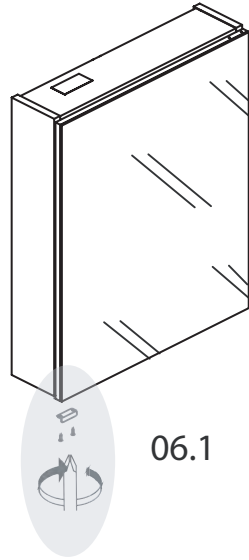
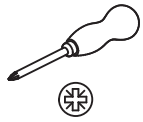

06.1

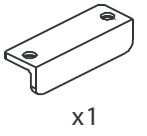
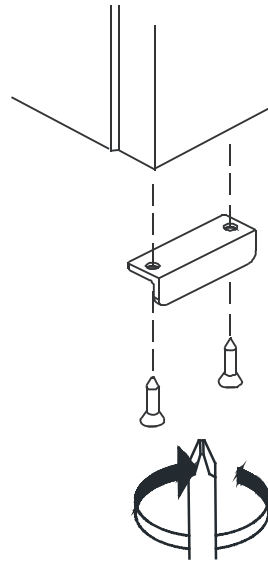

07.

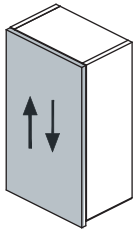

07.1

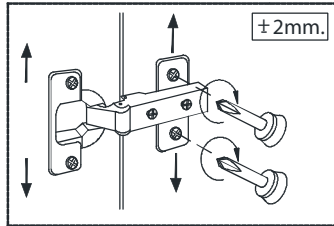

±2mm.

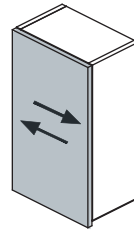

07.2

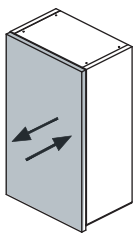
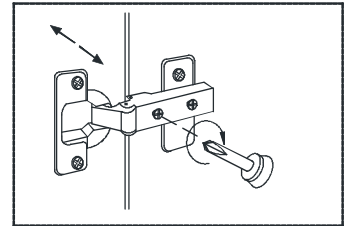

07.3

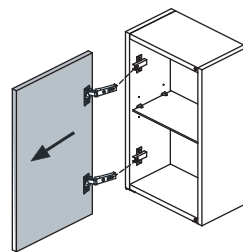
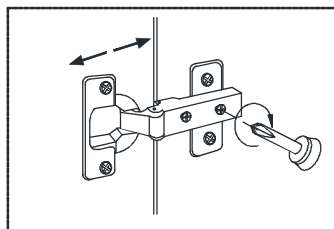

07.4

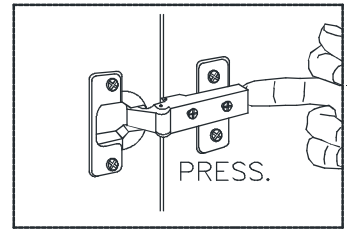

PRESS.

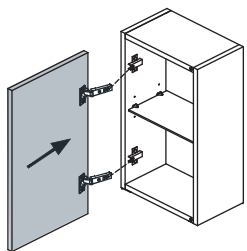

07.5

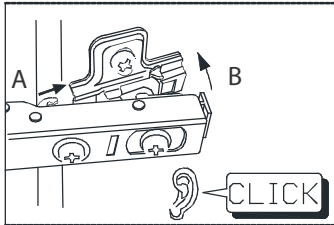

CLICK

# 08.

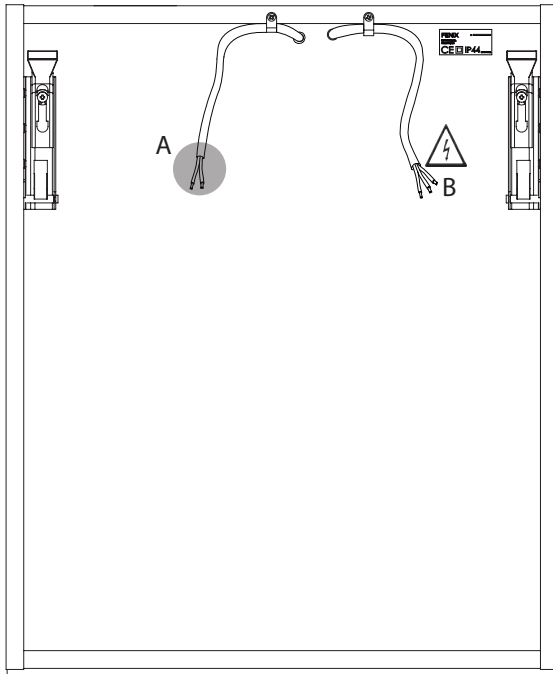
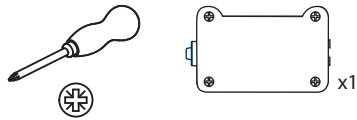

## 08.1 A

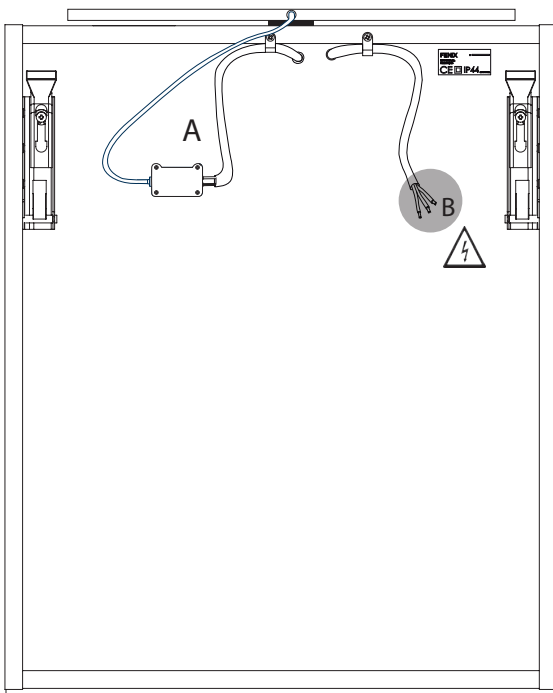
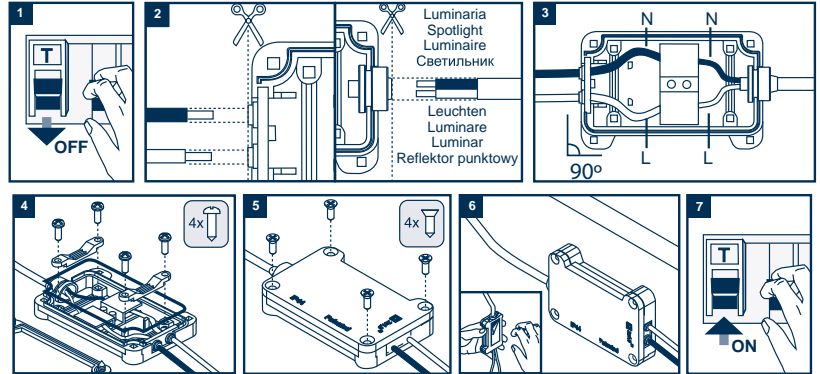

## 08.2 B

